



Specifications

Power: 5-24V DC
Standby Current: ≤ 35 mA
Operating Current: ≤ 100 mA
Smart Assistant Support: Yes
Operating Temperature: -40°C to $+60^{\circ}\text{C}$
Operating Methods: MOBILE APP
Wi-Fi: 2.4GHZ ONLY, Up To 10 Metre Distance (1 Wall)

About

The Tekno WF WiFi Switch allows for one or multiple users to control the connected device from anywhere in the world using the Tuya APP. It can be used to control automatic gates, garage doors, electric strikers and other access control systems requiring a short or long latching circuit. The Tekno can also be set to work with the major assistants like google and Alexa for operation by voice commands and setting scenes.



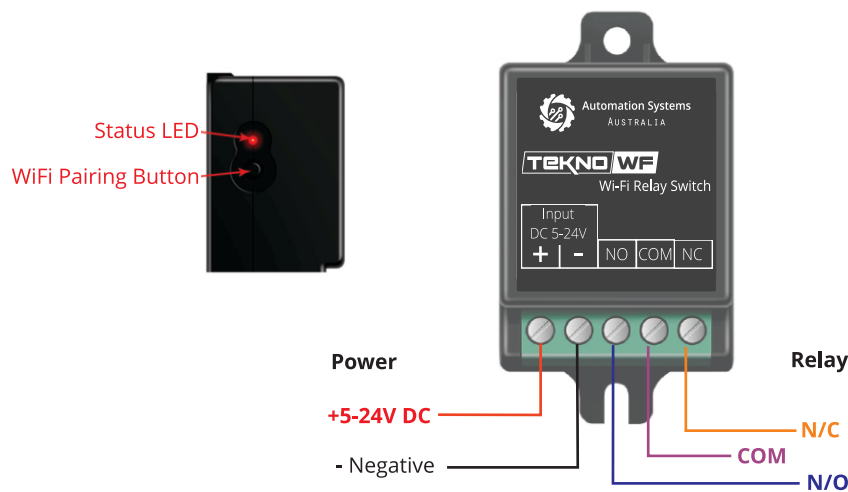

Overview



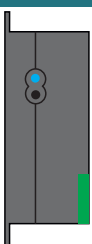

LED Indicator and WiFi Pairing





 Press the button ONCE to trigger the relay (based on the setting within the Tuya APP).

Latching ON Time

  Press and HOLD the button for 7 Seconds to enter the WiFi Pairing Mode.

0.5s 0.5s
WiFi Pairing Mode

  Not Connected

1s 1s
WiFi Not Connected

Premier SW24 Swing Gate Controller

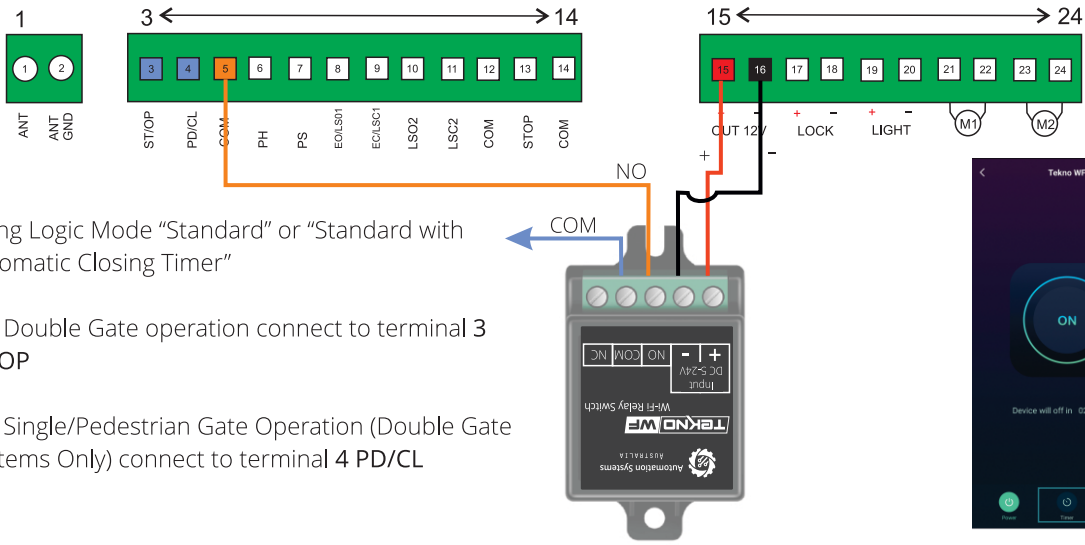

Using Logic Mode "Standard" or "Standard with Automatic Closing Timer"

For Double Gate operation connect to terminal 3 ST/OP

For Single/Pedestrian Gate Operation (Double Gate Systems Only) connect to terminal 4 PD/CL

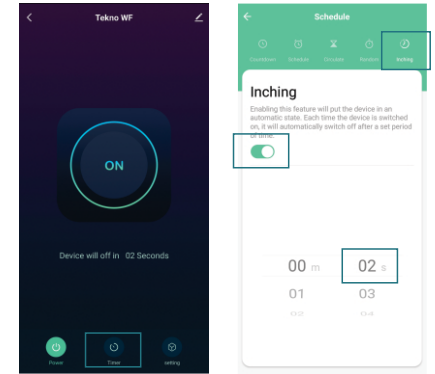

After adding the device to the APP set an "Inching" time of 02 seconds.

Premier SL24 Sliding Gate Controller

Using Logic Mode "Standard" or "Standard with Automatic Closing Timer"

For Full Gate operation connect to terminal 3 ST/OP

For Pedestrian Gate Operation connect to terminal 4 PD/CL

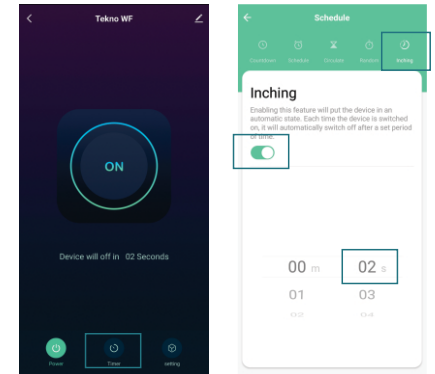
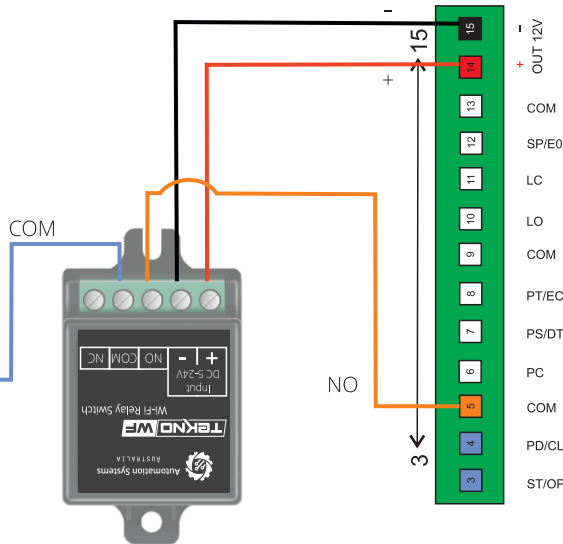

After adding the device to the APP set an "Inching" time of 02 seconds.

Premier SL240AC Sliding Gate Controller

For Full Gate operation OPEN and CLOSE connect to terminal START 19

For OPEN Gate Operation ONLY connect to terminal OPEN 21

For CLOSE Gate Operation ONLY connect to terminal CLOSE 20

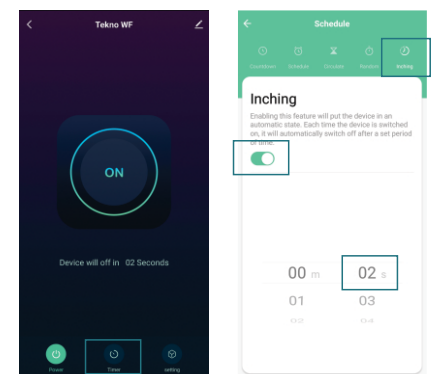
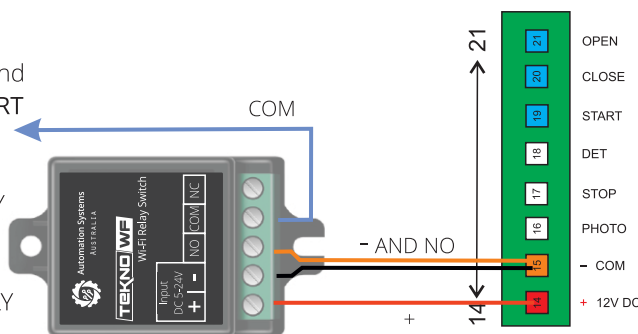

After adding the device to the APP set an "Inching" time of 02 seconds.

Electric Striker (Direct) FAIL SECURE/POWER ON TO UNLOCK

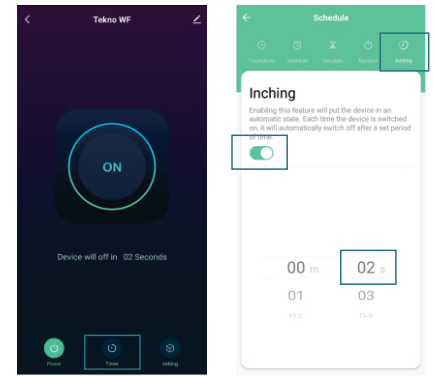
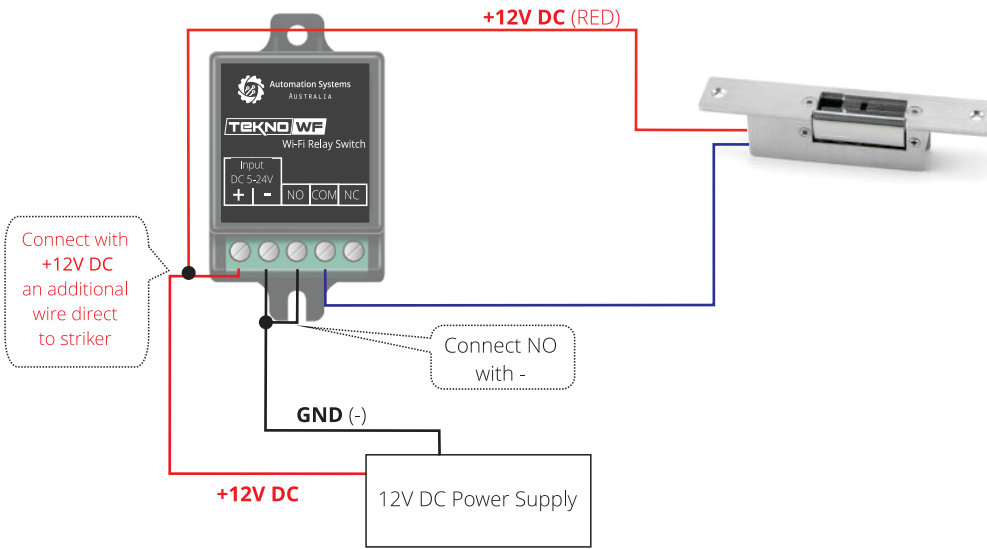

After adding the device to the APP set an "Inching" time of anywhere between 02 and 15 seconds.

Electric Striker (Direct) FAIL SECURE/POWER OFF TO UNLOCK

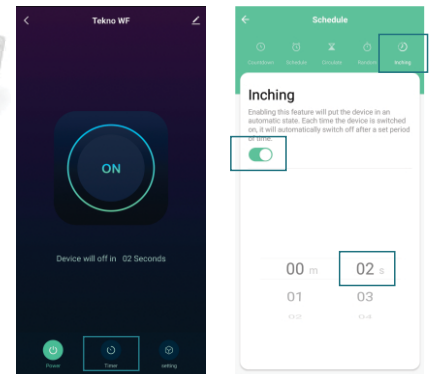
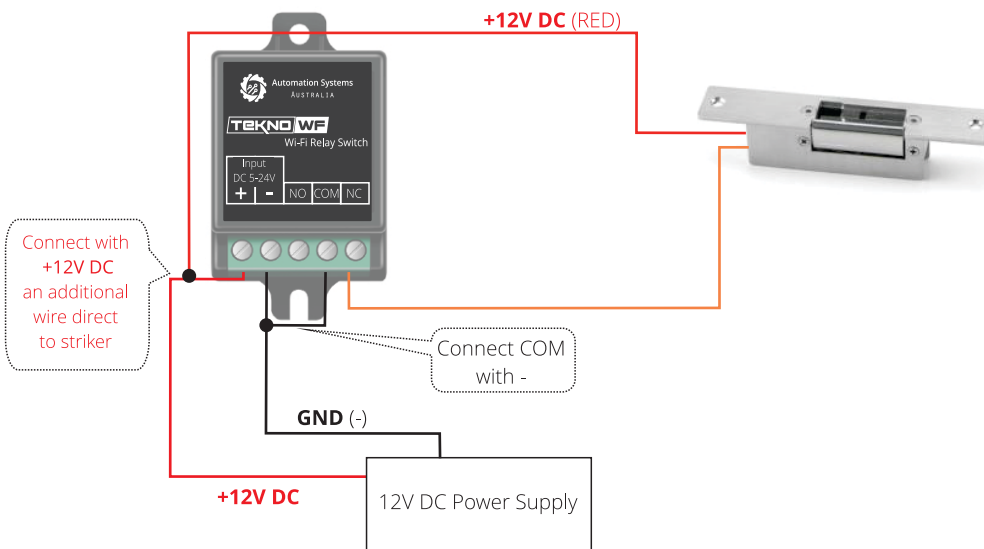

After adding the device to the APP set an "Inching" time of anywhere between 02 and 15 seconds.

Lock Control Power Supply

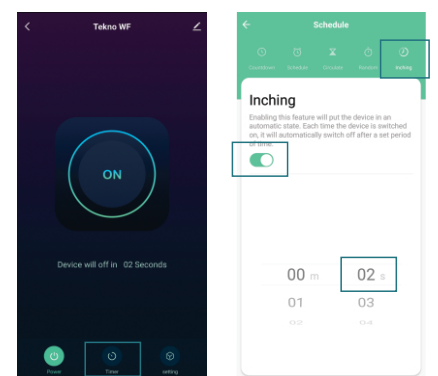
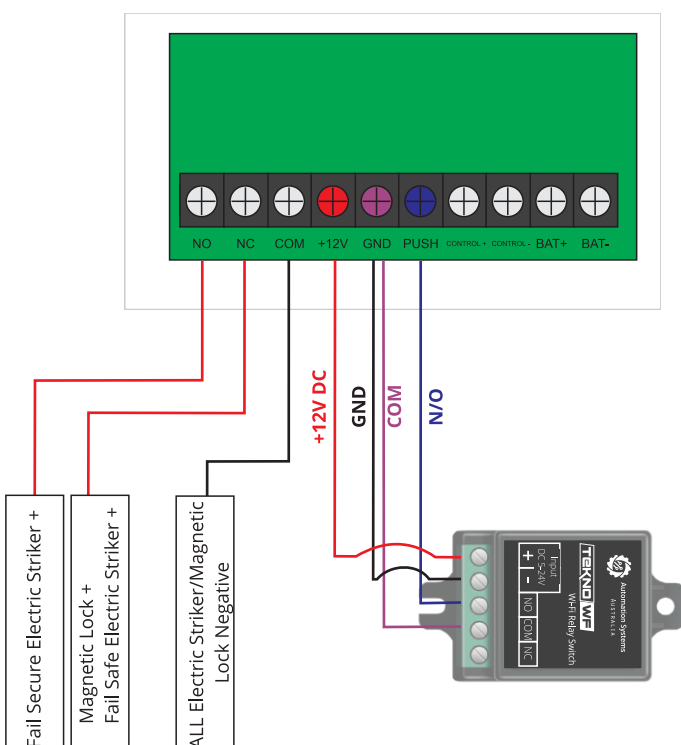

After adding the device to the APP set an "Inching" time of 02 seconds.

Download the TuyaSmart App on the Apple App Store or the Google Play Store



Then register your first user in the APP

Administrator User (Home Owner)

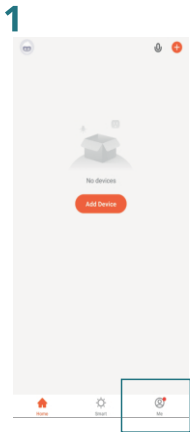

Select "me"

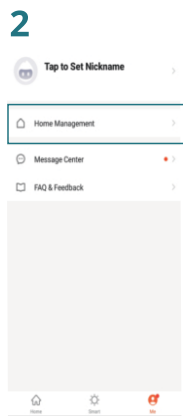

Select "Home Management"

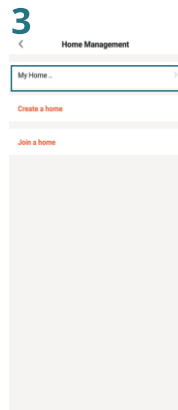

Select "My Home"

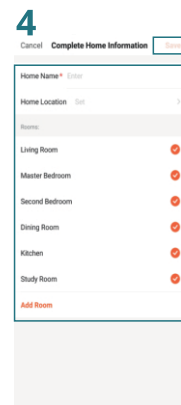

Fill in the information then Save

Add the Tekno WF to the ADMINISTRATOR USER Account

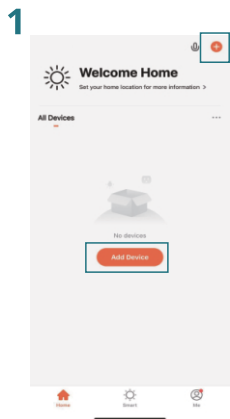

Select "Add Device" or "+" in the top right



3

If Wi-Fi and Bluetooth are turned OFF turn them ON and ensure you connect to your 2.4GHZ Wi-Fi Network.

Select Camera and Lock

Then select Lock (Wi-Fi)

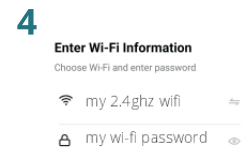

Ensure it is the correct Wi-Fi and enter your Wi-Fi password.

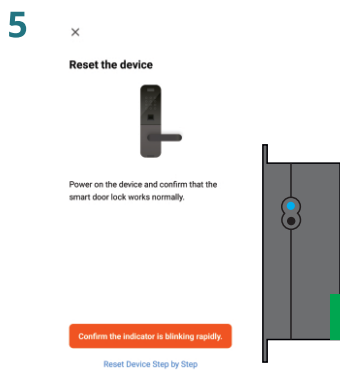

You will be prompted to reset the device (Wi-Fi Pairing Mode) press and HOLD the button for 7 Seconds to enter the WiFi Pairing Mode.

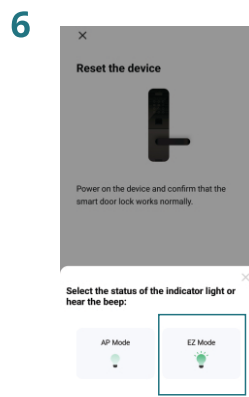

Select EZ Mode

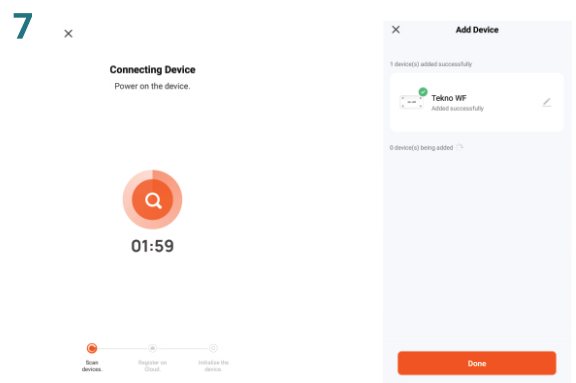

Allow the device 1-2 Minutes to be configured and connected.

Set the RELAY SETTING according to the system its connected to, see page 5.

Sharing access with a User (common users and additional admin's)

Ensure any users to be added have installed the APP and registered an account. This will simplify the process and avoid complications.

1

Select "me"

2

Select "Home Management"

3

Select "My Home"

4

Select the shared rooms
Select "Add Member"

5

6

Input the registered users email and details.

Administrator
Total Control including unlocking and adding/deleting users

Common Member
Control over unlocking only

Press SAVE when complete

Select Tuya App Account

Relay Mode and Schedules

Relay Latching (Inching)

With "Inching" OFF the circuit is in a latching state. First toggle is ON, next toggle is OFF. This relay is best suited to turn ON/OFF systems.

For devices such as gates and garage doors "Inching" should be ON and set to the minimum time of 02 seconds.

Ideal settings
Automatic gates and garage Inching 02 Seconds
Electric Strikers Inching 10 seconds
Appliances INCHING OFF

Schedule

Schedules allow for automatic operation as per your configuration. Add you scheduled operations here for automatic operation of your connected system at the specified day(s) and time(s).

Smart Assistants

Scan the relevant QR code for a brief guide on adding to your preferred assistant.



Warranty Terms and Conditions

The product is warranted for a period of twelve months (one year) from the date of purchase, unless expressly specified as extended warranty (extension to the warranty period). The product is to be installed for its intended purpose and for normal use as outlined within the installation manual, the product warranty is exclusively for defects in manufacturing and manufacturing workmanship. It does not cover out of guidelines use, natural or other disasters, abnormal weather conditions, damage incurred in shipping or handling, damage caused by disaster such as fire, flood, wind, earthquake, lightning, excessive voltage, mechanical shock, water damage, damage caused by unauthorized attachment, alterations, modifications, or foreign objects, damage caused by peripherals (unless such peripherals were supplied by Automation Systems Australia), defects caused by failure to provide a suitable installation environment for the products, damage caused by usage of the products for purpose other than those for which it was designed, damage from improper maintenance, damage arising out of any other abuse, mishandling, and improper application of the products.

At its discretion Automation Systems Australia will require the item determined by the support staff to be returned to base in its original unmodified condition for a warranty inspection if within the warranty period. A return authorization "RA" number will be provided to be enclosed with the product in question. The warranty will not cover freight fees to base, customs fees or any labour costs at the installation site but will cover repair or replacement of the product as seen fit. Automation Systems Australia will cover the freight of the returned item to the original address if deemed as a warranty repair or replacement item. Any warranty repairs or replacements continue to carry through the remaining warranty period and do not extend or restart the period.

Under no circumstances shall Automation Systems Australia be liable for any special, incidental, or consequential damages based upon breach of warranty, breach of contract, negligence, strict liability, or any other legal theory. Such damages include, loss of profits, loss of the product or any associated equipment, cost of capital, cost of substitute or replacement equipment, facilities or services, down time, purchaser's time, the claims of third parties, including customers, and injury to property.

This warranty contains the entire warranty and shall be in lieu of any and all other warranties, whether expressed or implied (including all implied warranties of merchantability or fitness for a particular purpose). And of all other obligations or purporting to act on its behalf to modify or to change this warranty, nor to assume for it any other warranty or liability concerning this product.

Automation Systems Australia will at its option repair or replace out-of-warranty products at a determined cost which are returned to its base according to the following conditions. Anyone returning goods to Automation Systems Australia must first obtain an authorization number. Automation Systems Australia will not accept any shipment whatsoever for which prior authorization has not been obtained. Products which Automation Systems Australia determines to be repairable will be repaired and returned. A set fee which Automation Systems Australia has been predetermined and which may be revised from time to time will be charged for each unit repaired. Products which Automation Systems Australia determines not repairable will be replaced by the nearest equivalent product available at that time. The current market price for the replacement product will be charged for each replacement unit.